

LANDSCAPE PLANTING NOTES

1. THE LANDSCAPE CONTRACTOR SHALL FURNISH ALL LABOR, EQUIPMENT, MATERIALS AND SERVICES FOR THE COMPLETE INSTALLATION AS DESCRIBED BY THE LANDSCAPE DRAWINGS.
2. ANY DEVIATION FROM THE PLAN IS TO HAVE PRIOR WRITTEN APPROVAL BY THE OWNER OR HIS REPRESENTATIVE.
3. THE LANDSCAPE CONTRACTORS TO REMOVE ALL WEEDS AND OR GRASSES (INCLUDING THE ROOTS) EXISTING IN THE PROPOSED GROUND COVER AREA.
4. THE PROPOSED GROUND COVER AREA SHALL RECEIVE THE PRE-EVENT HERBICIDE SURT-LAN 75V PER MANUFACTURERS INSTRUCTIONS. APPLICATION OF THIS HERBICIDE SHALL BE DONE BY PERSONNEL LICENSED TO HANDLE AGRICULTURAL CHEMICALS.
5. ROOTING OF THE PLANTS SHALL BE DONE ON THE LANDSCAPE CONTRACTOR'S SCHEDULE. THE FINISH GRADE SHALL BE SET TO A SMOOTH GRADE. LOOSENING TO THE SOIL TO A DEPTH OF 6" AND REMOVING ALL ROCKS OR CLDS OF 2" DIAMETER IS INCLUDED. FINISH GRADE IS TO BE 2" BELOW TOP OF ADJACENT CURBS AND SIDEWALKS.
6. ALL LANDSCAPE AREAS ARE TO RECEIVE AN EVEN APPLICATION OF 6 CUBIC YARDS OF NITROGEN FERTILIZER STABILIZED WOOD SAWDUST, 30 POUNDS OF 6N-20P-20K FERTILIZER, 10 LB. OF SOIL SULFUR FOR EACH 1,000 SQUARE FEET. THE ABOVE AMENDMENTS ARE TO BE INCORPORATED UNIFORMLY INTO THE TOP 6" OF SOIL.
7. ALL ROCK OR UNBROKEN SOIL CLDS OVER 1" IN DIAMETER BROUGHT TO THE SURFACE BY THE CONTRACTOR SHALL BE RESPONSIBLE FOR THE HORTICULTURAL SOILS CONDITIONING AMENDMENTS AND PLANTING BACKFILL. ALL MATERIALS SHALL BE IN ACCORDANCE TO SOIL AND PLANT LAB RECOMMENDATIONS. SOIL AND PLANT LAB: (714) 282-8777, 1594 N. MAIN STREET, ORANGE, CA 92667
8. GROUNDCOVERS ARE TO BE PLANTED SO THAT AFTER SETTLING, THE CROWN OF THE PLANTS IS EVEN WITH FINISH GRADE. ROOTS FULLY COVERED WITH SOIL AND FIRMED.
9. WATERING OF PLANTS IS TO TAKE PLACE IMMEDIATELY AFTER PLANTING.
10. MULCH ALL SHRUB AND GROUNDCOVER AREAS WITH A 1" LAYER OF 1/2" TO 3/4" REDWOOD BARK.
11. AT THE COMPLETION OF ALL PLANTING OPERATIONS, THE PREMISES ARE TO BE LEFT NEAT AND CLEAN. ALL SURPLUS MATERIALS, NURSERY TAGS AND WASTE ARE ARE TO BE REMOVED FROM THE SITE.
12. THE LANDSCAPE CONTRACTORS TO MAINTAIN ALL LANDSCAPE AREAS FOR A PERIOD OF THIRTY CALENDAR DAYS FROM THE DATE OF COMPLETION, ESTABLISHED BY THE OWNER OR HIS REPRESENTATIVE. ALL AREAS ARE TO BE KEPT WELL WATERED, FREE OF GRASSES AND TRASH DURING THIS MAINTENANCE PERIOD.
13. AN APPLICATION OF FERTILIZER (16% NITROGEN, 6% PHOSPHORIC, 8% POTASH) IS TO BE MADE JUST PRIOR TO THE COMPLETION OF THE MAINTENANCE PERIOD, OR AT 30 DAYS INTERVALS IF MAINTENANCE PERIOD IS GREATER THAN 30 DAYS.
14. ALL TREES, SHRUBS AND PLANT MATERIAL (OTHER THAN PLANTED MATERIAL) LESS THAN 15 GALLON SIZE SHALL BE GUARANTEED FOR A PERIOD OF 1 MONTH.
15. 15 GALLON SIZE SHALL BE GUARANTEED FOR A PERIOD OF 90 DAYS. ALL MATERIAL LARGER THAN 15 GALLON SIZE SHALL BE GUARANTEED FOR A PERIOD OF 1 YEAR.

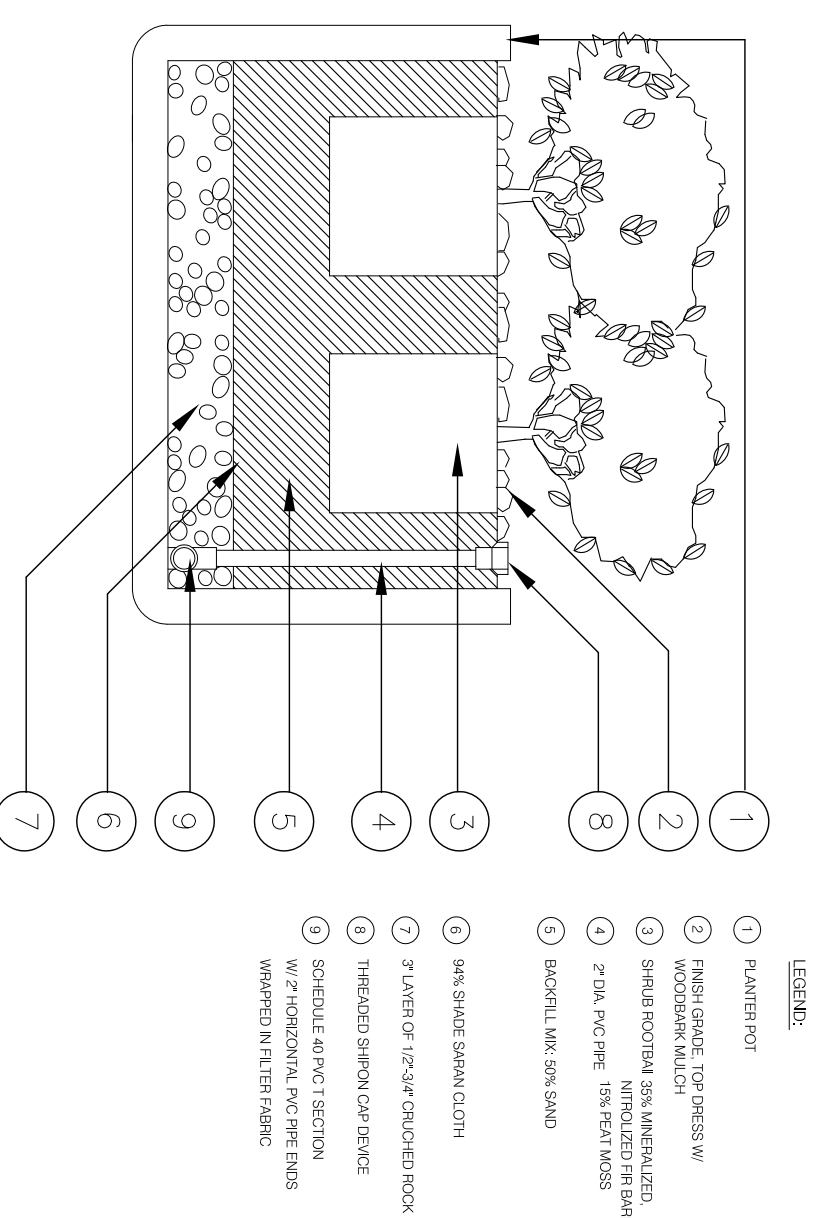

7 PLANTING POT

SCALE: NO SCALE

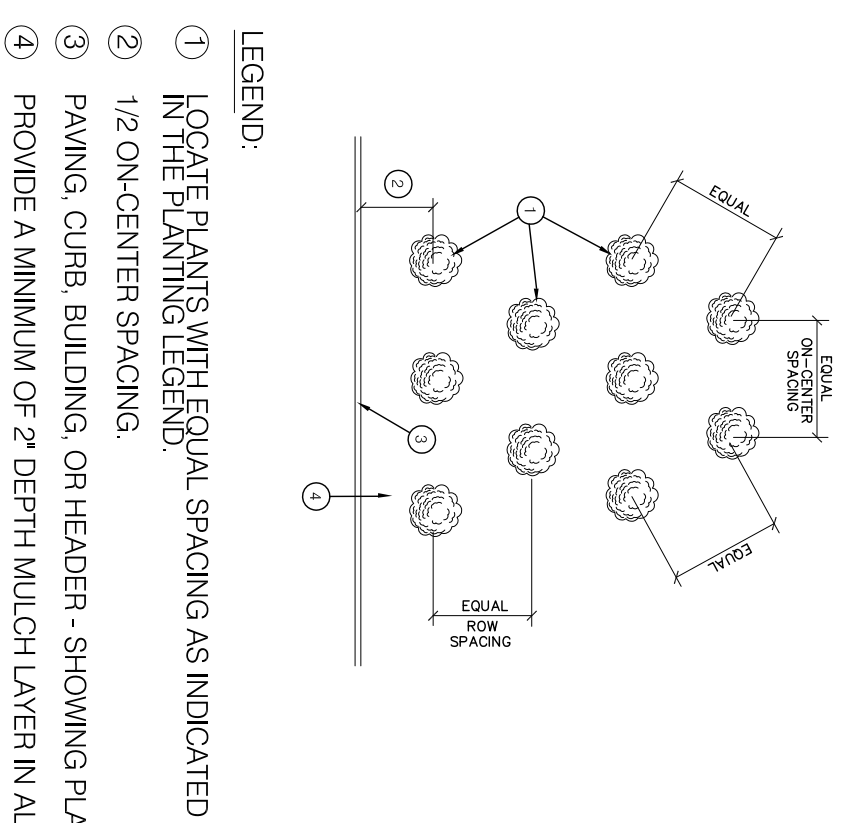

4 SHRUB & GROUNDCOVER SPACING

SCALE: NO SCALE

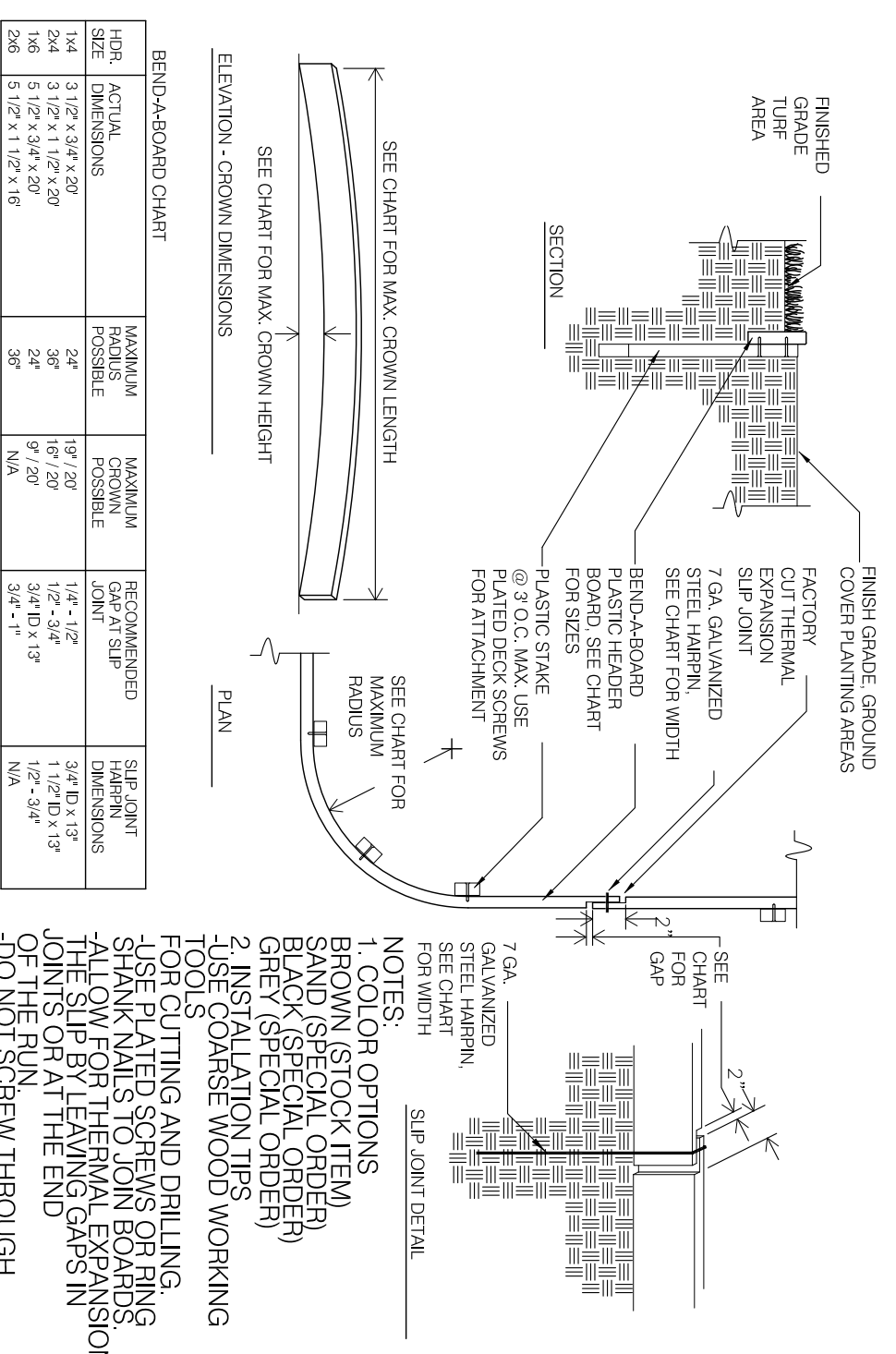

5 PLASTIC EDGING

SCALE: NO SCALE

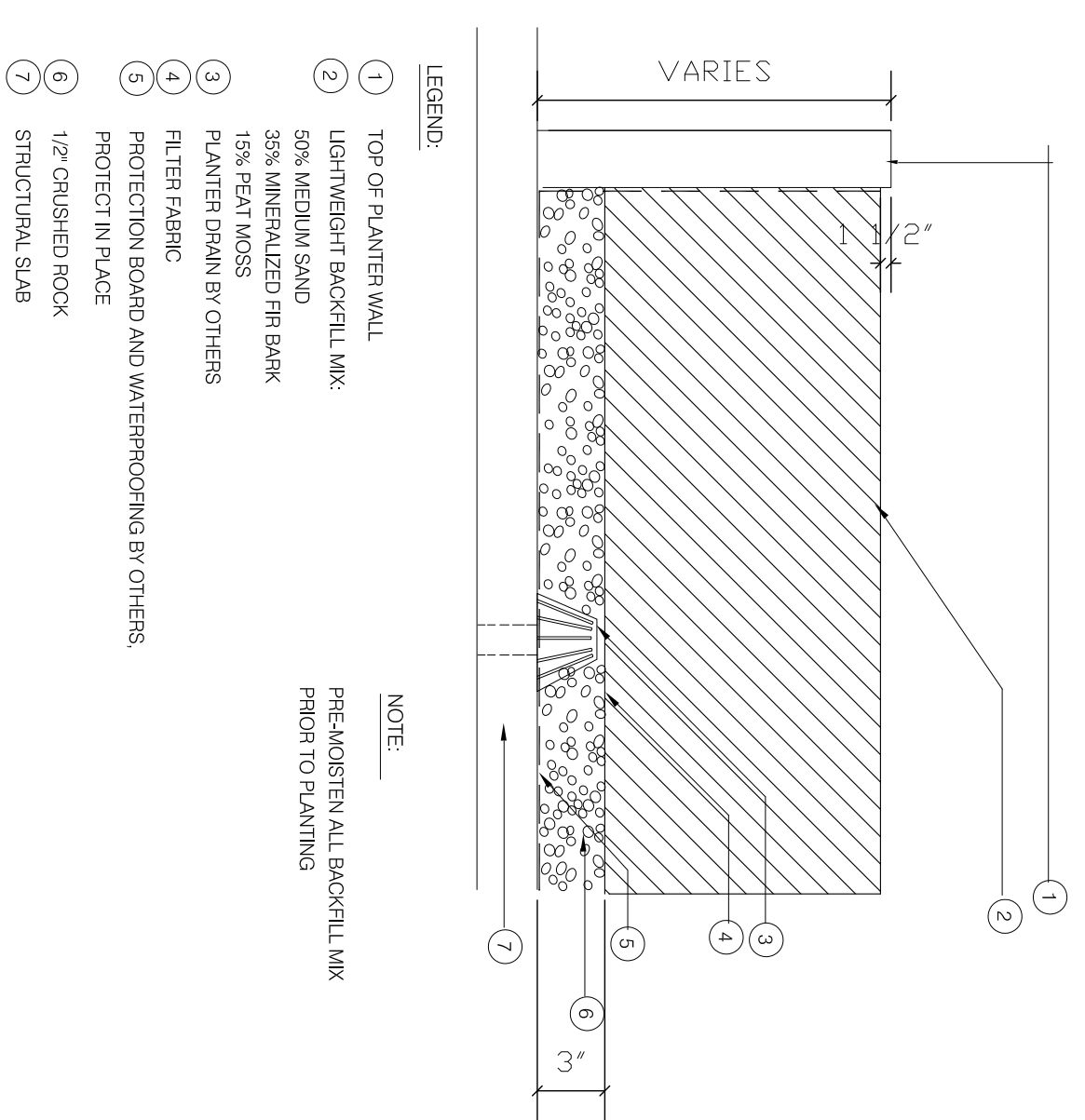

6 OVERSTRUCTURE PLANTER

SCALE: NO SCALE

1 TREE PLANTING

SCALE: NO SCALE

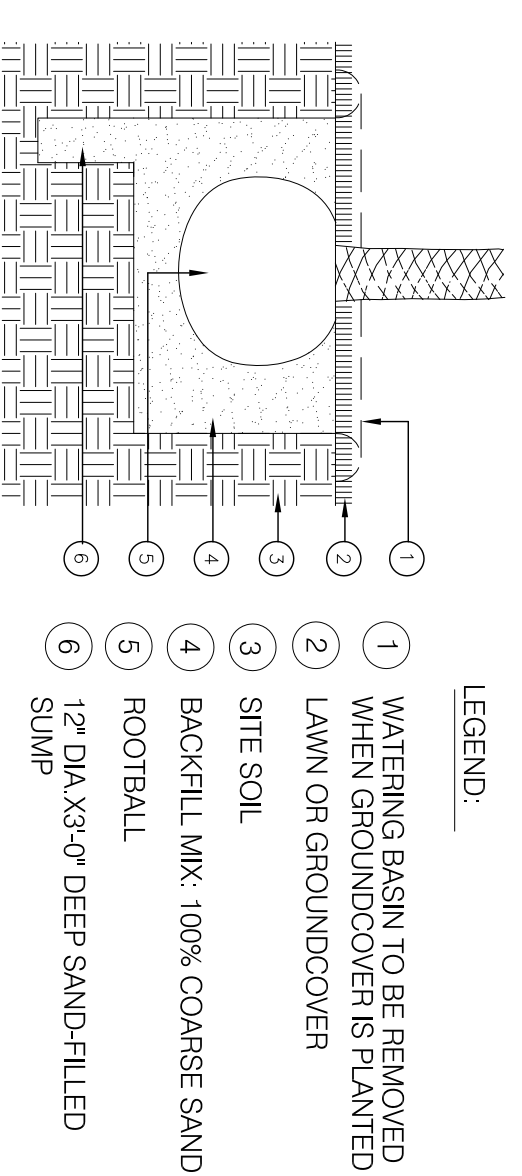
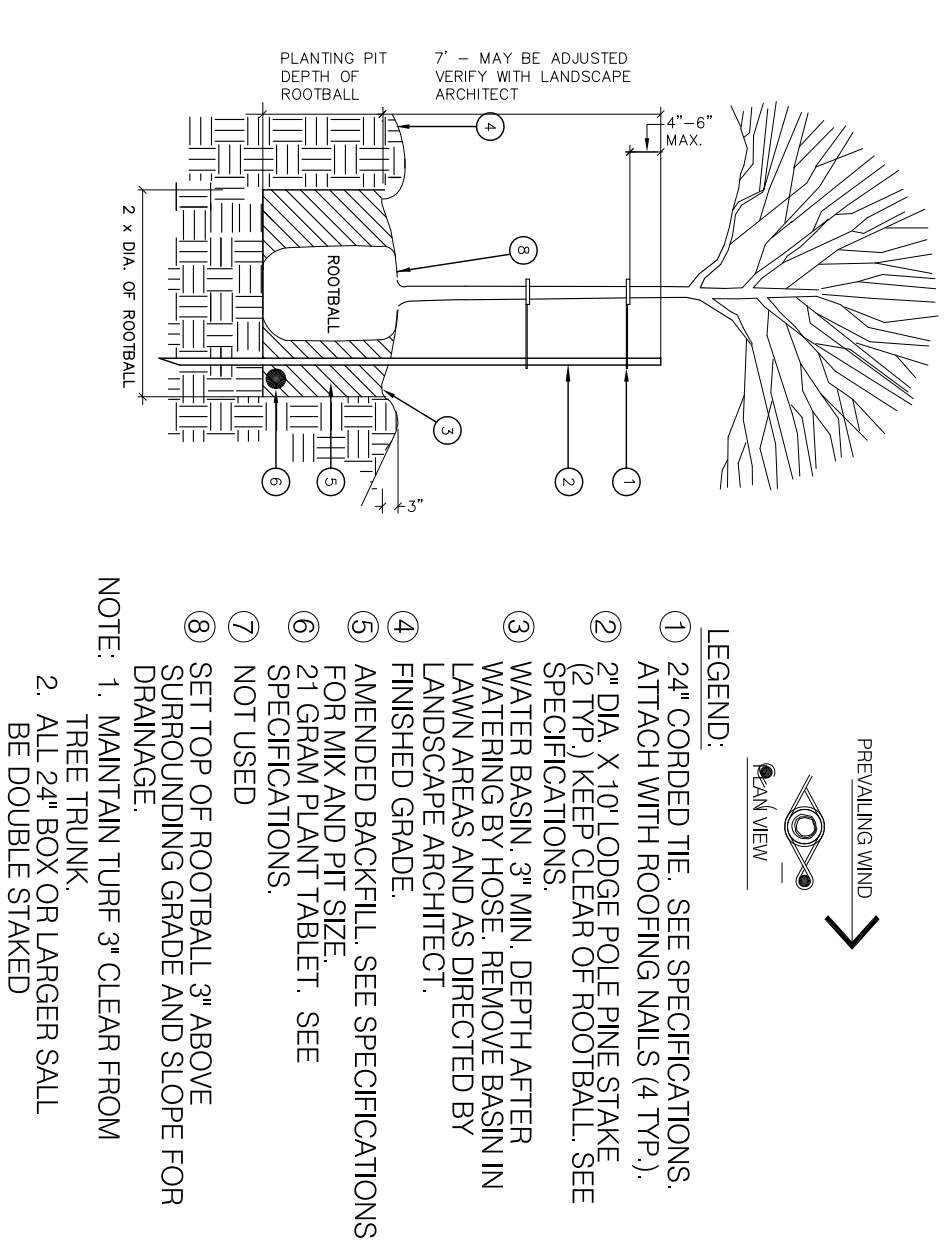

2 PALM PLANTING

SCALE: NO SCALE

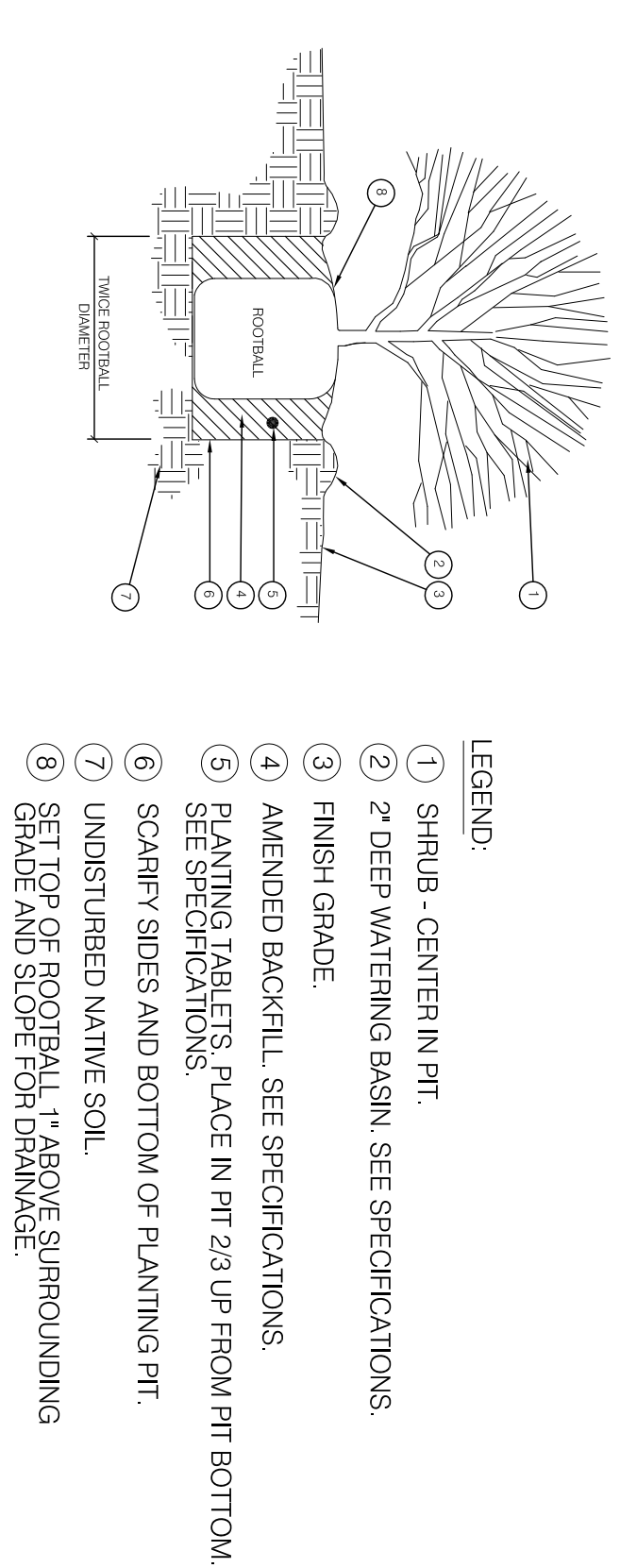

3 SHRUB PLANTING

SCALE: NO SCALE

No.	REVISION	DATE

TITLE
PLANTING DETAIL

SCALE
SCALE: NO SCALE

DATE
DATE: 11-15-06

NOT TO SCALE
NOT TO SCALE

SHEET NUMBER
LP-2

MR. ALI MADANI & MR. HOSSEIN ASHTIANI
5 UNIT CONDOMINIUMS at
1327 EUCLID STR., SANTA MONICA, CA-90404

L&V ARCHITECTS
1514 17th Street, Suite 207
Santa Monica, CA 90404
Tel. (310) 829 0996; Fax. (310) 829 7889